

Instruction Manual



■ CHARACTERISTICS

- 1. Analogue & digital time displays:** Hour, Minute, Second, Month, Date and day of the week.
- 2. Time Indication:** 12-hour display format with PM indicator and 24-hour display format are available.
- 3. Daily alarm:** The alarm can be set to sound at the designated time on a 24-hour basis.
- 4. Chime:** The chime can be set to sound every hour on the hour with a single beep.
- 5. Stopwatch:** The stopwatch can measure up to 23 hours 59 minutes and 59 seconds in 1/100-second increments. Lap time measurement is available.
- 6. 100 M Water Resistant**
- 7. Illuminating light:** The built-in electroluminescent (EL) backlight illuminates the display for easy viewing in darkness.

■ DISPLAY AND BUTTON OPERATION

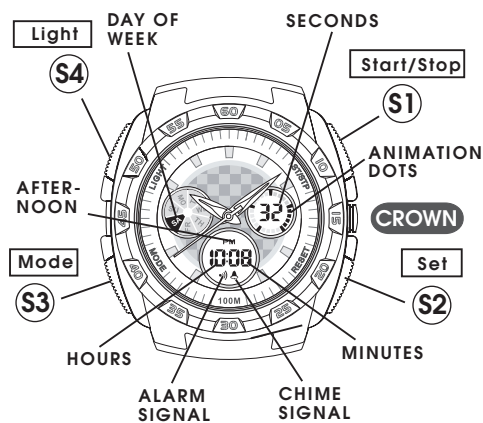

- * Press S2 button and hold to show the ALARM TIME. Release S2 button to return to the NORMAL TIME display.
- * Press S1 button and hold to show the MONTH/DATE or DATE/MONTH. Release S2 button to return to the NORMAL TIME display.
- * Press S3 button at any time to return to the NORMAL TIME display.

■ SETTING THE TIME (ANALOGUE)

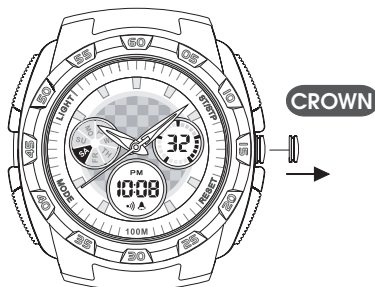

1. Pull the crown out one step, the second hand will stop.
 2. Set the correct time by turning the crown.
 3. Push the crown back to the original position. The watch will start running again.
- * **The analogue indication and digital display of the time setting can be adjusted separately.**

■ HOW TO SET NORMAL TIME

1. From NORMAL TIME display, press and hold S3 button for 2 seconds to show the ALARM TIME display. The hour digits start flashing.
 - * The display is changed automatically to the ALARM TIME after 2 seconds.
2. Press S3 button again to move on to SECONDS setting. The second digits start flashing.
3. Press S2 button to set SECONDS setting.
4. Press S1 button to move on to MINUTES setting.
 - * Selection of the digits to be adjusted (flashing) is made in the order below by pressing S1 button and then pressing S2 button to be set.
5. After all the adjustment are completed, press S3 button to return to the NORMAL TIME display.

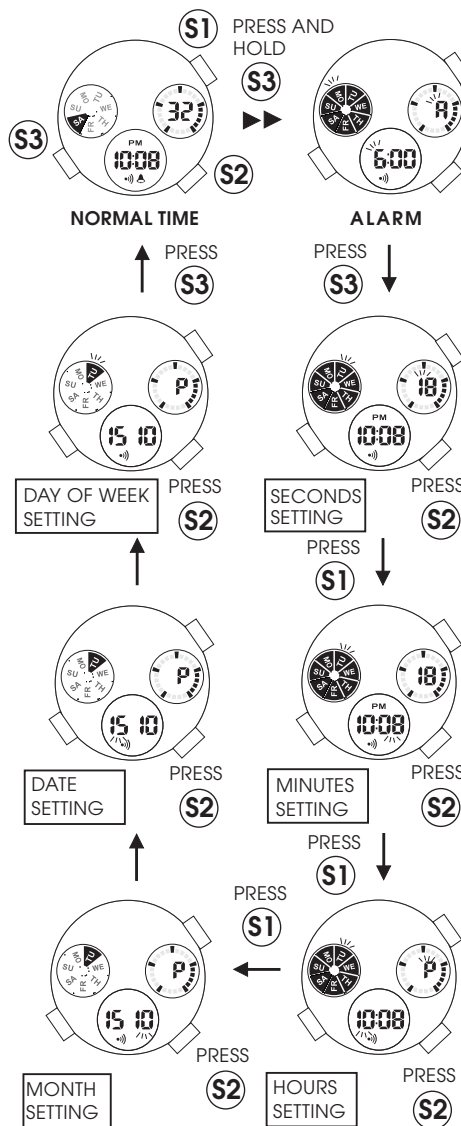

■ HOW TO SWITCH 12-HOUR/24-HOUR FORMAT

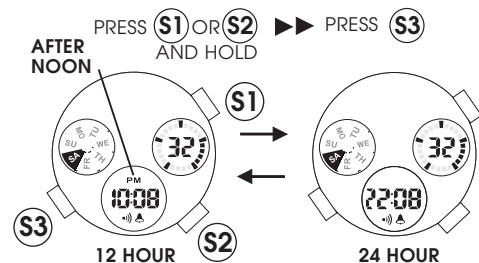

1. Press S1 or S2 button and hold it. Then press S3 button to switch the display.
- * The time display format in either 12-hour indication or in 24-hour indication can be selected alternately.
- * Under the 12-hour indication format, "PM" mark appears in the afternoon, but no AM mark appears in the morning. Under the 24-hour indication format, no mark appears on the display.

■ HOW TO DISPLAY MONTH/DATE

1. From NORMAL TIME display, press S1 button and hold it to show the MONTH/DATE display.
 2. Press S2 button to switch to the DATE/MONTH display.
 3. Press S2 button again to switch back to the MONTH/DATE display.
- * The display format in either DATE/MONTH indication or in MONTH/DATE indication can be selected alternately by pressing S2 button.

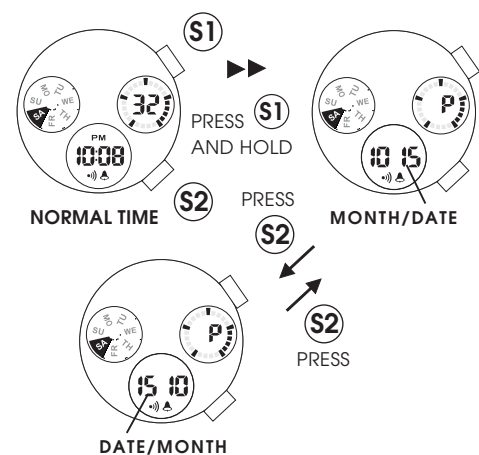

■ HOW TO SET ALARM TIME

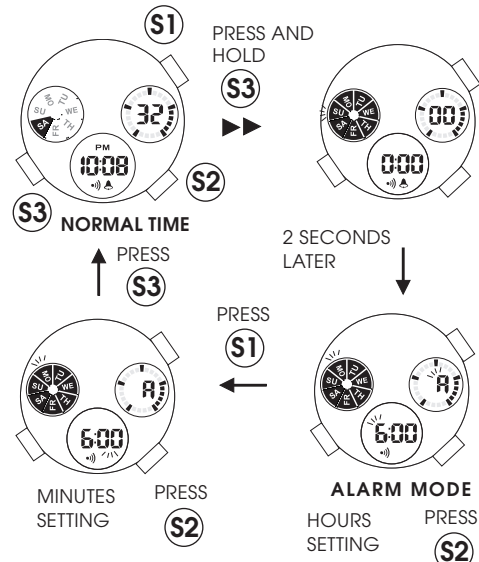

1. From NORMAL TIME display, press and hold S3 button for 2 seconds to show the ALARM TIME display. The hour digits start flashing.
 - * The display is changed automatically to the ALARM TIME after 2 seconds.
2. Press S2 button to set HOURS setting.
3. Press S1 button to move on to MINUTES setting.
4. Press S2 button to set MINUTES setting.
5. After all the setting are completed, press S3 button to return to the NORMAL TIME display.

Engagement/Disengagement of ALARM & CHIME

- * Press S2 button and hold it, and then press S1 button, the ALARM and CHIME can be engaged or disengaged in the order below.
- * The ALARM signal and/or CHIME signal appear or disappear on the display accordingly.

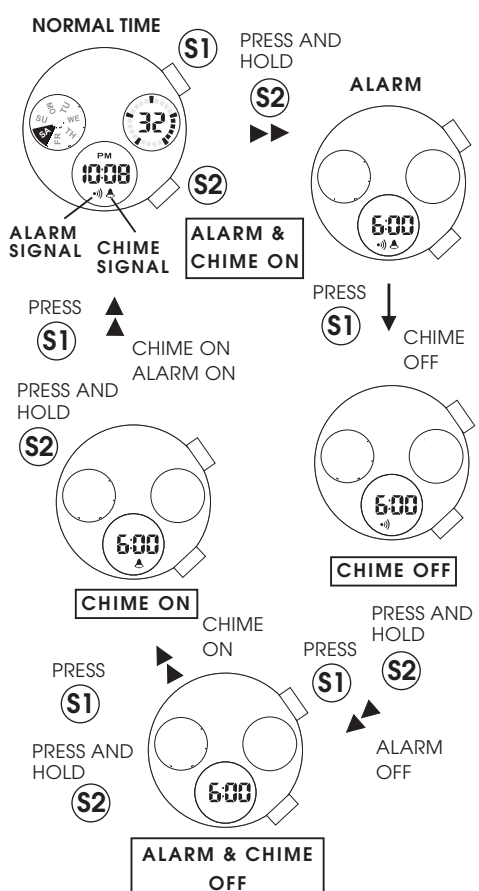

* From NORMAL TIME display, press S3 button to go to the STOPWATCH mode.